

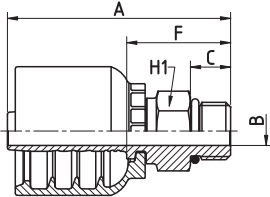

OPNS TYPE

SAE OR BOSS STANDARD CONNECTIONS



OPNS13010

SAE MALE O-RING BOSS TYPE - SAE J516/J514

PART. REF.	HOSE BORE			THREAD	DIMENSIONS inch				
	DN	inch	Size		B	A	C	F	H ₁
OPNS13010-06-06	10	3/8"	- 06	9/16" - 18	0.28	2.17	0.39	1.01	0.67
OPNS13010-06-08	10	3/8"	- 06	3/4" - 16	0.37	2.28	0.44	1.13	0.87
OPNS13010-08-08	12	1/2"	- 08	3/4" - 16	0.37	2.36	0.44	1.14	0.87
OPNS13010-08-10	12	1/2"	- 08	7/8" - 14	0.49	2.48	0.50	1.26	0.98
OPNS13010-10-12	16	5/8"	- 10	1. 1/16" - 12	0.59	2.83	0.59	1.48	1.26
OPNS13010-12-12	19	3/4"	- 12	1. 1/16" - 12	0.59	2.99	0.59	1.56	1.26
OPNS13010-12-16	19	3/4"	- 12	1. 5/16" - 12	0.78	3.01	0.59	1.57	1.50
OPNS13010-16-16	25	1"	- 16	1. 5/16" - 12	0.78	3.52	0.59	1.62	1.50

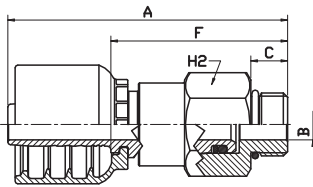

OPNS14310

SAE SWIVEL MALE O-RING BOSS TYPE - SAE J516/J514

PART. REF.	HOSE BORE			THREAD	DIMENSIONS inch				
	DN	inch	Size		B	A	C	F	H ₁
OPNS14310-06-06	10	3/8"	- 06	9/16" - 18	0.28	2.96	0.39	1.81	0.87
OPNS14310-08-08	12	1/2"	- 08	3/4" - 16	0.37	3.23	0.44	2.00	1.06